

TECHNICAL DATA

S298 Coolant Level Switch – Capacitance Type with Voltage Output

FOZMULA
INNOVATION IN SENSORS



The **S298** is an active device designed to give an alarm signal if liquid falls below, or rises above, a preset level. It can be specified with a delay to eliminate false alarms due to turbulence.

Containing a factory programmable microprocessor and an integral 3-pin Metripack 150 connector, this switch can be configured to provide most industry standard voltage outputs.

Its small footprint with limited intrusion into the tank means a reduced risk of damage and a wide range of customer specifiable options make it suitable for many applications.

SPECIFICATION

Liquid types:	Water based liquids such as coolant or washer fluid.
Electrical rating	
Supply voltage:	5±0.25 VDC.
Supply current:	5 mA + source output.
Alarm delay time:	0 to 10 s rising or falling (factory set).
Connection:	3 way Packard Metripack 150 connector.
Power up delay:	1 to 10 s (factory set).
Power up state:	'In Liquid' or 'Out of Liquid' (factory set).
Output type:	Voltage.
Output pin:	Pin B.
Output state in liquid*:	1.25±0.25 VDC
Output state in air*:	3.75±0.25 VDC
Output current:	10 mA.

Connections: See diagram below.

*Outputs are factory selectable; opposite states and alternative values from 0.5-4.5 VDC are available on request.

Environmental Ratings

Ingress:	IP67
Max. pressure:	5.0 Bar (72 psi)
Temp. range:	-40 °C to +125 °C (-40 °F to + 257 °F)
Weight:	70 g typical (dependent on thread size)
EMC:	ISO10605, ISO11452-1 & ISO11452-3

Construction

Body:	Brass.
Probe:	PTFE.
Terminals:	Brass, Tin Plated.
Seals:	EPDM & FVMQ.
Connector:	PA66 30% Glass Filled Nylon.
Thread sealant:	Vibra-Seal 516 on request.

Vibration (15.3 Grms)

3 orthogonal planes for 3 hours per plane
Testing performed in accordance with BSEN 60068-2-64:1993

Frequency (Hz) g² Hz⁻¹

24	0.4
60	0.5
100	0.5
240	0.1
2000	0.1

Drop: 1 m to concrete surface.

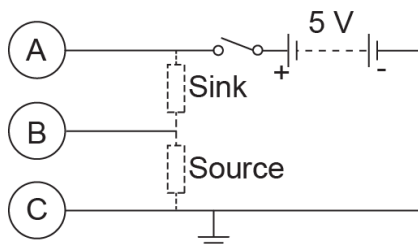
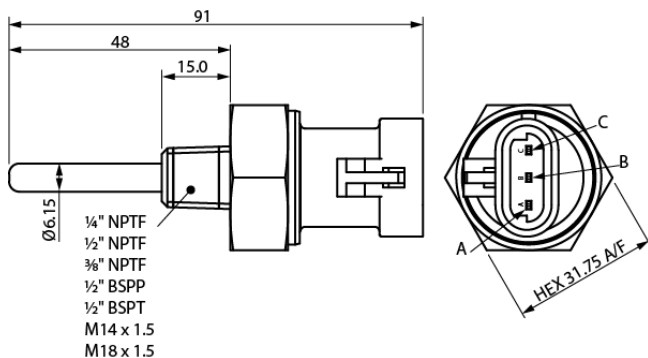

Optional accessories

Mating connector kit to suit harness wire cross sectional area of 0.8 to 1.0 mm² and sleeve Ø1.60 to 2.15 mm:

Our Part no	Description
C/Kx	Connector kit comprising of: Crimp Terminals (x3) Cable seals (x3) Cavity plug (x1) Connector assembly 3 way (x1) TPA lock (x1)

From the Packard Metri-Pack 150 series of connectors.

Hermes Close | Tachbrook Park | Warwick | CV34 6UF | United Kingdom
Tel: +44 (0)1926 466700 | Fax: +44 (0)1926 450473 | sales@fozmula.com

www.fozmula.com

E. & O. E. © Fozmula Limited.

Since the suitability of these products depends upon a wide range of factors not in our control, Fozmula Limited expects and understands that you will conduct the testing and evaluation necessary to determine that these products are suitable for your application. Whilst every effort is made to ensure the above details are correct at the time of printing, Fozmula Limited reserves the right to make material changes, and or technical changes without notification.

JP 24-Nov-15 3.4 rev 1